

**IP65 Test Report**

<b>Test Item:</b> IP65 Test		<b>File No:</b> SDT-003963
<b>Product Name:</b> IPPC1202-RE V-A1	<b>S/N:</b> S02IPPC12--A10100P	<b>Quantity:</b> 1
<b>Date:</b> 2015 / 08 / 06	<b>Temperature:</b> 23.4°C	<b>Humidity:</b> 46.0%RH
<b>Place:</b> Intertek Lab & SGS Lab	<b>Inspector:</b> Kevin	<b>Leader:</b> Tony Tsai

**Configuration:**

Item	Description	S/N
LCD Panel	IVO / 12.1" TFT-LCD [M121GNX2 R1]	A003LCDM121GNX000P
Touch panel	ELO / 12.1" 5-WIRE RESISTIVE ZERO-BEZEL [E803003]	A003LCDPANEL07600P
CASE	IPPC-1202-RE V-A1	Y02IPPC12020A1100P

**Test Equipment:**

Equipment	Manufacturer	Model Number
Dust test chamber	PTL	14.41

Name	Brand	Model	Serial No.
IPX5 Water Jet Hose Nozzle Set	PTL	P03.26	5050565

**Test Result:**

Front side	IP6X	IPX5	Conclusion
Result	Pass	Pass	Pass

**Test Purpose**

Test for degrees of protection provided by enclosures.

**Test Condition:**

- Test Area (Front Bezel)



## IP6X

The test was performed with reference to IEC/EN 60529 IP6X

1. Test for protection against solid foreign objects:

- Test method: Dust test
- Sample condition: Non-Operating
- Type of dust: Talcum Powder
- Talcum Powder size: < 0.075 mm
- The amount of dust: 2 kg per cubic meter
- The chamber size: 1 m<sup>3</sup>
- The maximum depression: -20 mbar
- Test duration: 8 hours

## IPX5

The test was performed with reference to IEC/EN 60529 IPX5

1. Test for protection against water:

- Test means: Spraying the enclosure from all practicable directions with a stream of water from a standard test nozzle as specified in test standard.
- Sample condition: Non-Operating
- Internal diameter of the nozzle: 6.3 mm
- Delivery rate: 12.5 liter/minute  $\pm 5\%$
- Distance from nozzle to enclosure surface: between 2.5m to 3m
- Core of the substantial stream: circle of approximately 40 mm diameter at 2.5m distance from nozzle
- Test duration: Total 3 minutes

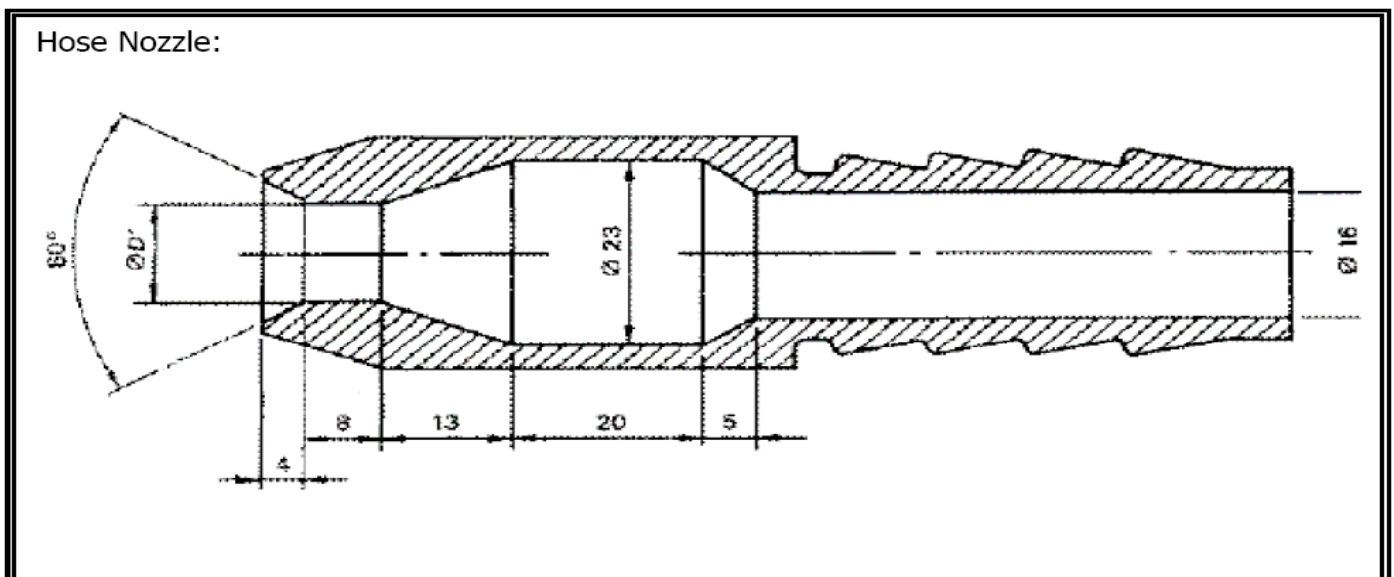

**Testing Photos:**

**IPX5 Test Photo**



**Before IP6X Test Photo**



**After IP6X Test Photo**

